

RESOLUTION NO. _____

A RESOLUTION OF THE TOWN COUNCIL OF THE TOWN OF MAMMOTH LAKES, STATE OF CALIFORNIA, DECLARING ITS INTENTION TO ESTABLISH A COMMUNITY FACILITIES DISTRICT AND TO AUTHORIZE THE LEVY OF SPECIAL TAXES THEREIN

TOWN OF MAMMOTH LAKES
COMMUNITY FACILITIES DISTRICT NO. 2023-1
(MAINTENANCE SERVICES)

WHEREAS, under the Mello-Roos Community Facilities Act of 1982 (Sections 53311 and following, California Government Code; hereafter referred to as the “Act”), the Town Council of the Town of Mammoth Lakes (the “Town”) may commence proceedings for the establishment of a community facilities district; and

WHEREAS, this Town Council has received a Petition (including Waivers) from the landowners requesting that it establish a community facilities district under the Act to provide for the costs of plowing and removal of snow, and maintenance of curbs/sidewalks, landscapes and streetlights and related appurtenances, and this Town Council now desires to commence proceedings to establish a community facilities district as described herein; and

WHEREAS, this Town Council has previously adopted local goals and policies for the formation of community facilities districts within the Town; and

WHEREAS, under the Act, this Town Council is the legislative body for the proposed community facilities district and is empowered with the authority to establish the community facilities district and levy special taxes within the community facilities district; and

WHEREAS, this Town Council now desires to proceed with the actions necessary to consider the establishment of the community facilities district.

NOW, THEREFORE, BE IT RESOLVED, by the Town Council of the Town of Mammoth Lakes, as follows:

1. The Town Council hereby finds that the facts set forth in the recitals to this Resolution are true and correct and establish the factual basis for the Town Council’s adoption of this Resolution.
2. This Town Council proposes to conduct proceedings to establish the community facilities district pursuant to the Act, and hereby determines that public convenience and necessity require the formation of the community facilities district to fund public services.
3. The name of the proposed community facilities district is Town of Mammoth Lakes, Community Facilities District No. 2023-1 (Maintenance Services) (the “District”).
4. The proposed boundaries of the District are as shown on the map of the District on file with the Town Clerk, a copy of which is attached hereto as Exhibit A, which Exhibit is by this reference incorporated herein. The proposed boundaries are hereby preliminarily

approved. The Town Clerk is hereby directed to record, or cause to be recorded, the map of the boundaries of the District in the office of the Mono County Recorder no later than fifteen (15) days after the adoption of this Resolution.

5. The type of services proposed to be funded by the District by proceeds of the special tax shall consist of those services described in Exhibit B hereto, which Exhibit is by this reference incorporated herein (the "Services").

The Town Council hereby determines that the Services are necessary to meet increased demands for such services placed upon local agencies as the result of development occurring within the area of the District. The Services are in addition to those provided in the territory of the District as of the date hereof and will not supplant services already available within the territory of the District as of the date hereof.

6. Except where funds are otherwise available, a special tax sufficient to pay the costs thereof, secured by the recordation of a continuing lien against all non-exempt real property in the District, will be levied annually within the District and collected in the same manner as ordinary ad valorem property taxes or in such other manner as this Town Council or its designee shall determine, including direct billing of the affected property owners. The proposed rate and method of apportionment of the special tax among the parcels of real property within the District, in sufficient detail to allow each landowner within the proposed District to estimate the maximum amount such owner will have to pay, is described in Exhibit C attached hereto, which Exhibit is by this reference incorporated herein. The special tax shall be levied perpetually until the collection of the special tax by the Town ceases.
7. This Town Council finds that the provisions of Section 53313.6, 53313.7 and 53313.9 of the Act (relating to adjustments to ad valorem property taxes and schools financed by a community facilities district) are inapplicable to the District.
8. The levy of said proposed special tax shall be subject to the approval of the qualified electors of the District at a special election. The proposed voting procedure shall be by mailed or hand-delivered ballots among the landowners in the proposed District, with each landowner having one vote for each acre or portion of an acre of land such landowner owns in the District.
9. Except as may otherwise be provided by law or the rate and method of apportionment of the special tax for the District, all lands owned by any public entity, including the United States, the State of California, and/or the Town, or any departments or political subdivisions of any thereof, shall be omitted from the levy of the special tax to be made to cover the costs and expenses of the Services and any expenses of the District.
10. The Director of Public Works of the Town is hereby directed to study the proposed Services and to make, or cause to be made, and file with the Town Clerk a report required by Section 53321.5 of the Act presenting the following:

- (a) A brief description of the Services.
- (b) An estimate of the fair and reasonable initial annual cost of providing the Services, including the incidental expenses in connection therewith, any Town administration costs and all other related costs.

Said report shall be made a part of the record of the public hearing provided for below. The Director of Public Works may delegate to consultants the duty to perform the study and prepare the report.

- 11. Wednesday, April 5, 2023, at 4:00 p.m. or as soon thereafter as the matter may be heard in the regular meeting place of this Town Council at Suite Z, Minaret Village Shopping Center, 437 Old Mammoth Road, Town of Mammoth Lakes, California, or virtually as noticed by the Town, are hereby appointed and fixed as the time and place when and where this Town Council, as legislative body for the District, will conduct a public hearing on the establishment of the District and consider and finally determine whether the public interest, convenience, and necessity require the formation of the District and the levy of said special tax.
- 12. The Town Clerk is hereby directed to cause notice of said public hearing to be given by publication one time in a newspaper published in the area of the District. The publication of said notice shall be completed at least seven (7) days before the date herein set for said hearing. The notice shall be substantially in the form of Exhibit D hereto.
- 13. This Resolution shall take effect immediately upon its adoption.

APPROVED AND ADOPTED this 15th day of February 2023.

JOHN WENTWORTH, Mayor

ATTEST:

JAMIE GRAY, Town Clerk

EXHIBIT A

TOWN OF MAMMOTH LAKES
COMMUNITY FACILITIES DISTRICT NO. 2023-1
(MAINTENANCE SERVICES)

PROPOSED BOUNDARIES OF THE DISTRICT

PROPOSED BOUNDARIES OF
TOWN OF MAMMOTH LAKES
COMMUNITY FACILITIES DISTRICT NO. 2023-1
(MAINTENANCE SERVICES)

TOWN OF MAMMOTH LAKES
COUNTY OF MONO
STATE OF CALIFORNIA

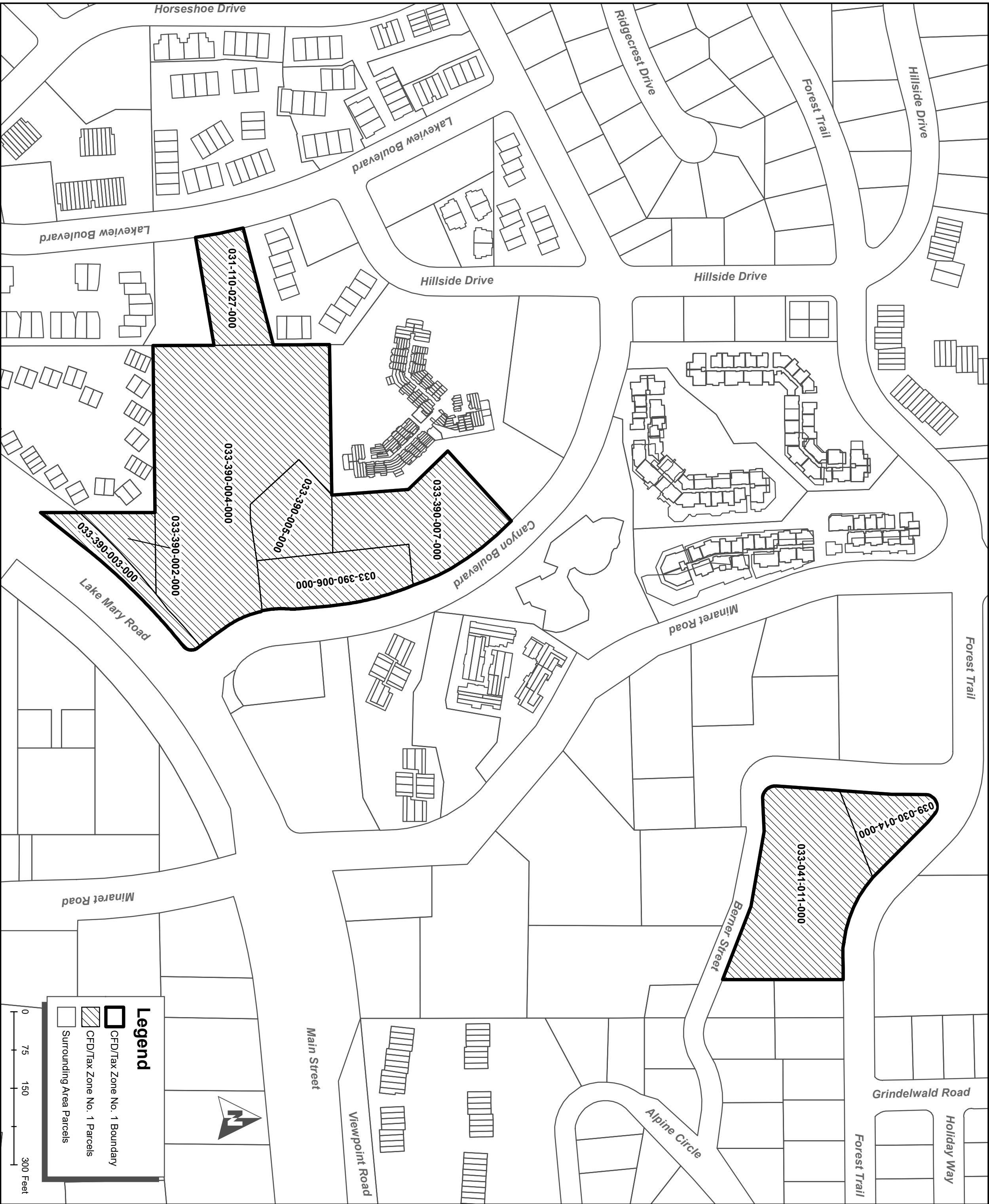

FILED IN THE OFFICE OF THE TOWN CLERK OF THE TOWN OF MAMMOTH LAKES THIS _____ DAY OF _____, 2023.

TOWN CLERK
TOWN OF MAMMOTH LAKES
MONO COUNTY, CALIFORNIA

I HEREBY CERTIFY THAT THE WITHIN MAP SHOWING THE PROPOSED BOUNDARIES OF TOWN OF MAMMOTH LAKES COMMUNITY FACILITIES DISTRICT NO. 2023-1 (MAINTENANCE SERVICES), TOWN OF MAMMOTH LAKES, COUNTY OF MONO, STATE OF CALIFORNIA, WAS APPROVED BY THE TOWN COUNCIL OF THE TOWN OF MAMMOTH LAKES AT A REGULAR MEETING THEREOF, HELD ON THE _____ DAY OF _____, 2023, BY ITS RESOLUTION NO. _____.

TOWN CLERK
TOWN OF MAMMOTH LAKES
MONO COUNTY, CALIFORNIA

FILED THIS _____ DAY OF _____, 2023, AT THE HOUR OF _____ O'CLOCK _____ M. IN BOOK _____ OF MAPS OF ASSESSMENT AND COMMUNITY FACILITIES DISTRICTS AT PAGE _____ IN THE OFFICE OF THE COUNTY RECORDER OF THE COUNTY OF MONO, STATE OF CALIFORNIA. INSTRUMENT NUMBER: _____

COUNTY RECORDER
COUNTY OF MONO, CALIFORNIA

FOR PARTICULARS OF THE LINES AND DIMENSIONS OF ASSESSOR PARCELS, REFERENCE IS MADE TO THE MAPS OF THE ASSESSOR, COUNTY OF MONO, STATE OF CALIFORNIA.

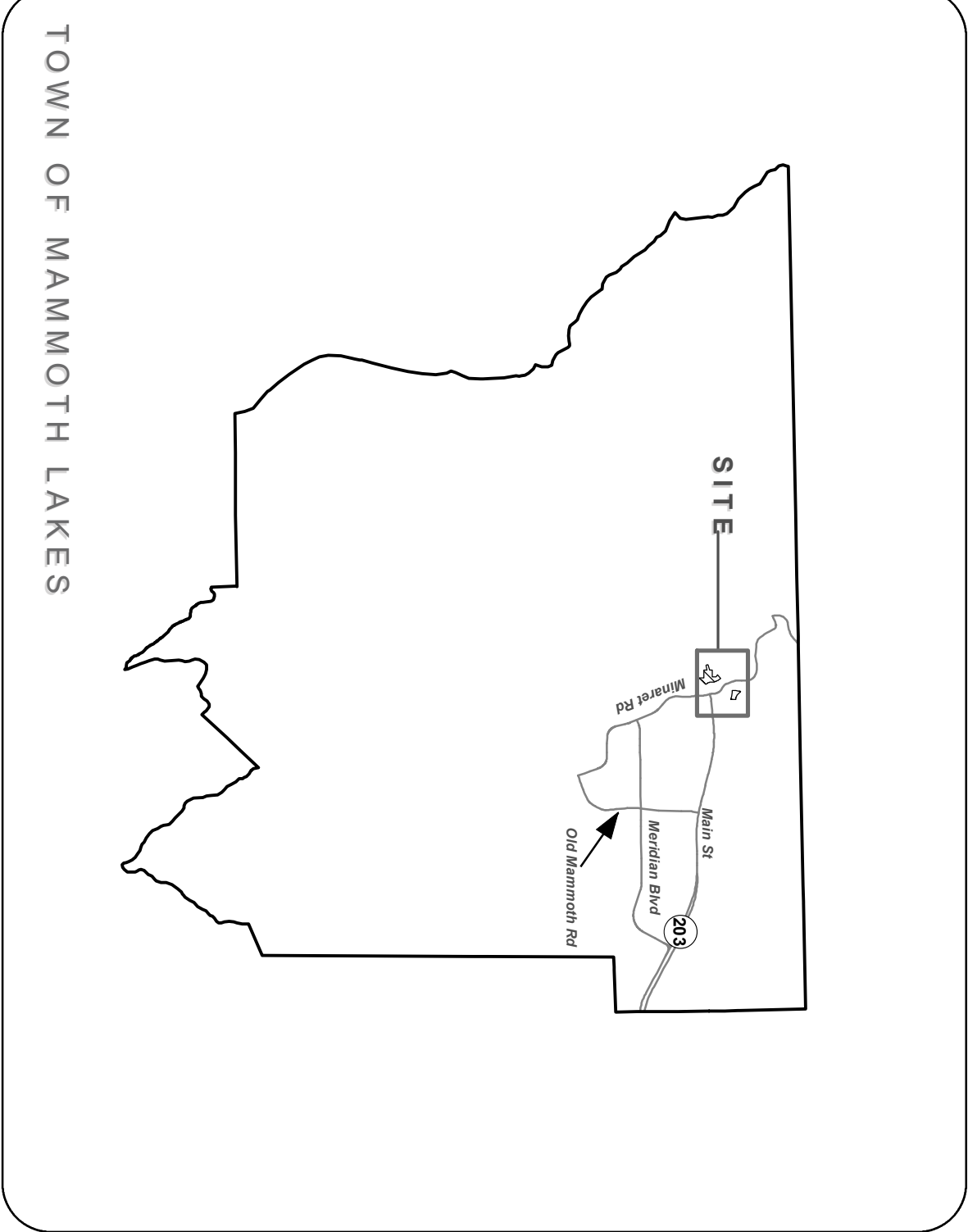

EXHIBIT B
TOWN OF MAMMOTH LAKES
COMMUNITY FACILITIES DISTRICT NO. 2023-1
(MAINTENANCE SERVICES)

DESCRIPTION OF SERVICES

It is intended that the District will be eligible to fund all or a portion of the direct and incidental costs of plowing and removal of snow, and maintenance of curbs/sidewalks, landscapes and streetlights and related appurtenances, within or adjacent to the District.

The District may fund any of the following related to the maintenance of the services described in the preceding paragraph: obtaining, constructing, reconstructing, furnishing, and operating and maintaining equipment, apparatuses or facilities related to providing the services; equipment, apparatuses, facilities, or fixtures in areas to be maintained; paying the salaries and benefits of personnel necessary or convenient to provide the services; payment of insurance costs and other related expenses; and the provision of reserves for repairs, replacements, and for the future provision of services. It is expected that the services will be provided by the Town, either with its own employees or by contract with third parties, or any combination thereof. The District may also fund administrative fees of the Town related to the District.

The services to be financed by the District are in addition to those provided in the territory of the District before the date of creation of the District and will not supplant services already available within that territory when the District is created.

EXHIBIT C

TOWN OF MAMMOTH LAKES
COMMUNITY FACILITIES DISTRICT NO. 2023-1
(MAINTENANCE SERVICES)

RATE AND METHOD OF APPORTIONMENT OF SPECIAL TAX

**RATE AND METHOD OF APPORTIONMENT
FOR TOWN OF MAMMOTH LAKES
COMMUNITY FACILITIES DISTRICT NO. 2023-1
(MAINTENANCE SERVICES)**

A Special Tax, as hereinafter defined, shall be levied and collected in Town of Mammoth Lakes Community Facilities District No. 2023-1 (Maintenance Services) ("CFD No. 2023-1") each Fiscal Year commencing in Fiscal Year 2022/23, in an amount determined by the application of the procedures below. All Taxable Property, as hereinafter defined, unless exempted by law or by the provisions hereof, shall be taxed for the purposes, to the extent and in the manner herein provided.

A. DEFINITIONS

The terms hereinafter set forth have the following meaning:

"Accessory Dwelling Unit" or "ADU" means all Assessor's Parcels of Single-Family Residential Property for which a building permit(s) has been issued for an "Accessory Dwelling Unit" as defined in California Government Code Section 65852.2(j)(1), as may be amended from time to time, which is accessory to a primary Unit. The ADU may be located on the same Assessor's Parcel as the primary Unit that is the primary Unit or on a separate Assessor's Parcel. For purposes of clarification, where an ADU and primary Unit are on the same Assessor's Parcel, the ADU located on such Assessor's Parcel is considered a separate Unit from the primary Unit on such Assessor's Parcel for purposes of the Special Tax. Should an Assessor's Parcel contain only an ADU, such Assessor's Parcel will be taxed as an ADU Unit only.

"Acre or Acreage" means the land area of an Assessor's Parcel as shown on an Assessor's Parcel Map or in the Assessor's Data for each Assessor's Parcel. In the event the Assessor's Parcel Map or Assessor's Data shows no Acreage, the Acreage for any Assessor's Parcel shall be determined by the CFD Administrator based upon the applicable final map, parcel map, condominium plan, or other recorded County parcel map. If the preceding maps are not available, the Acreage of an Assessor's Parcel may be determined utilizing GIS.

"Act" means the Mello-Roos Community Facilities Act of 1982, as amended, being Chapter 2.5, Division 2 of Title 5 of the Government Code of the State.

"Administrative Expenses" means the actual or reasonably estimated costs directly related to the administration of CFD No. 2023-1 including, but not limited to, the following: the costs of computing the Annual Special Tax Requirement and of preparing the Special Tax collection schedules; the costs of collecting the Special Tax, including any charges levied by the County Auditor's Office, Tax Collector's Office or Treasurer's Office; the costs of the Town or designee in complying with the disclosure requirements of the California Government Code (including the Act), including public inquiries regarding the Special Tax; the costs of the Town or designee related to an appeal of the Special Tax; and the costs of commencing and pursuing to completion any action arising from any delinquent Special Tax in CFD No. 2023-1. Administrative Expenses shall also include amounts estimated or advanced by the Town or CFD No. 2023-1 for any other administrative purposes, including, but not limited to, attorney's fees.

“Annual Services Costs” means the respective amounts determined by the CFD Administrator required to fund services authorized to be funded by CFD No. 2023-1 for the applicable yearly period.

“Annual Special Tax Requirement” means that amount with respect to CFD No. 2023-1 determined by the Town Council or designee as required in any Fiscal Year to pay: (1) the Administrative Expenses, (2) the Annual Services Costs, (3) any amount required to establish or replenish any reserve or replacement fund established in connection with CFD No. 2023-1, and (4) any reasonably anticipated delinquent Special Tax based on the delinquency rate for any Special Tax levied in the previous Fiscal Year.

“Apartment Property” means all Assessor’s Parcel of Developed Property with two or more Units that share a single Assessor’s Parcel Number, are offered for rent to the general public, and cannot be purchased by individual homebuyers, according to Assessor’s Data or as otherwise known by the CFD Administrator. Apartment Property does not include Hotel Property.

“Assessor’s Data” means Assessor’s Parcel Number, Units, Acreage, or other information contained in the records of the County Assessor for each Assessor’s Parcel.

“Assessor’s Parcel” or **“Parcel”** means a lot or parcel shown in an Assessor’s Parcel Map and/or Assessor’s Data with an assigned Assessor’s Parcel Number.

“Assessor’s Parcel Map” means an official map of the Assessor of the County designating parcels by Assessor’s Parcel Number.

“Assessor’s Parcel Number” means, with respect to an Assessor’s Parcel, that number assigned to such Assessor’s Parcel by the County Assessor for purposes of identification.

“Building Square Feet” or **“BSF”** means all of the square footage within the perimeter of a commercial structure or a residential structure, not including any carport, walkway, garage, overhang, patio, enclosed patio, or similar area. The determination of Building Square Feet shall be made by reference to the Assessor’s Data. If the Assessor’s Data does not show Building Square Feet, building permit(s) issued for such structure, or other records of the Town shall be used, as determined by the CFD Administrator.

“CFD Administrator” means an official of the Town, or designee thereof, responsible for determining the Annual Special Tax Requirement and providing for the levy and collection of the Special Taxes.

“CFD No. 2023-1” means the Town of Mammoth Lakes Community Facilities District No. 2023-1 (Maintenance Services).

“Condominium Property” means all Assessor’s Parcel of Developed Property with one Unit with a single Assessor’s Parcel Number that is a condominium, pursuant the definition in Civil Code Section 4125, or a townhome.

“Commercial Property” means all Assessor’s Parcel of Developed Property with a commercial use, according to Assessor’s Data or as otherwise known by the CFD Administrator.

“County” means the County of Mono.

“County Assessor” means the County Assessor of the County.

“Developed Property” means, in any Fiscal Year, all Taxable Property in CFD No. 2023-1 for which a building permit for new construction was issued by the Town prior to June 30 of the preceding Fiscal Year.

“Exempt Property” means all Assessors’ Parcels within the boundary of CFD No. 2023-1 which are exempt from the Special Tax pursuant to Section E.

“Final Map Property” means, in any Fiscal Year, all Taxable Property in CFD No. 2023-1 for which a Final Subdivision Map was approved by Town Council prior to June 30 of the preceding Fiscal Year.

“Final Subdivision Map” means a subdivision of property created by recordation of a final subdivision map, parcel map or lot line adjustment, approved by the Town pursuant to the Subdivision Map Act (California Government Code Section 66410 *et seq.*) or recordation of a condominium plan pursuant to California Civil Code 4120, that creates individual lots for which residential building permits may be issued without further subdivision of such property.

“Fiscal Year” means the period starting July 1 and ending on the following June 30.

“GIS” means a geographic information system.

“Hotel Property” means all Assessor’s Parcel of Developed Property used for the purpose of temporary, overnight lodging for which a fee is paid, and reservations are required, which is occupied or intended or designed for occupancy by transients for dwelling, lodging or sleeping purposes, and includes any hotel, inn, tourist camp, tourist court, tourist cabin, motel or any place in which rooms, lodgings or accommodations are furnished to transients for a consideration.

“Maximum Special Tax” means the maximum Special Tax authorized to fund the Annual Special Tax Requirement in any Fiscal Year that may apply to Taxable Property as described in Section C.

“Mixed-Use Property” means all Assessor’s Parcels of Developed Property that have more than one land use category, allowing for both residential and other use types on each such Assessor’s Parcel. For an Assessor’s Parcel of Mixed-Use Property, the Special Tax shall be calculated and levied for each use type present on the Assessor’s Parcel.

“Open Space Property” means property within the boundaries of CFD No. 2023-1 which (i) has been designated with specific boundaries and Acreage on a final subdivision map as open space, (ii) is classified by the County Assessor as open space, (iii) has been irrevocably offered for dedication as open space to the federal government, the State, the County, the Town, or any other public agency, or (iv) is encumbered by an easement or other restriction required by the Town limiting the use of such property to open space.

“Property Owner’s Association” means any property owner’s association. As used in this definition, a Property Owner’s Association includes any home-owner’s association, condominium owner’s association, master or sub-association or non-residential owner’s association.

“Property Owner’s Association Property” means any property within the boundaries of CFD No. 2023-1 which is (a) owned by a Property Owner’s Association or (b) designated with specific boundaries and acreage on a final subdivision map as property owner association property.

“Proportionately” means for Taxable Property that the ratio of the Special Tax levy to the Maximum Annual Special Tax is equal for all Assessors’ Parcels of Taxable Property levied within each property land use classification within CFD No. 2023-1.

“Public Property” means any property within the boundaries of CFD No. 2023-1 which (i) is owned by a public agency, (ii) has been irrevocably offered for dedication to a public agency, or (iii) is designated with specific boundaries and Acreage on a final subdivision map as property which will be owned by a public agency. For purposes of this definition, a public agency includes the federal government, the State, the County, the Town, school districts, or any other public agency.

“Single Family Residential Detached Property” means all Assessor’s Parcels of Developed Property for which a building permit(s) has been issued for a detached residential structure intended as a single primary Unit.

“Special Tax” means the amount levied in each Fiscal Year on each Assessor’s Parcel of Taxable Property to fund the Annual Special Tax Requirement.

“State” means the State of California.

“Tax Zone” means a mutually exclusive geographic area within which the Special Tax may be levied pursuant to this Rate and Method of Apportionment. ***All the Taxable Property within CFD No. 2023-1 at the time of its formation is within either Tax Zone No. 1.*** Additional Tax Zones may be created when property is annexed to CFD No. 2023-1, and a separate Maximum Special Tax shall be identified for property within each new Tax Zone at the time of such annexation. The Assessor’s Parcels included within a new Tax Zone when such Parcels are annexed to CFD No. 2023-1 shall be identified by Assessor’s Parcel number in the annexation documents at the time of annexation.

“Taxable Property” means all of the Assessor’s Parcels within the boundaries of CFD No. 2023-1 that are not exempt from the Special Tax pursuant to law or Section E below.

“Town” means the Town of Mammoth Lakes.

“Town Council” means the Town Council of the Town, acting as the legislative body of CFD No. 2023-1.

“Undeveloped Property” means all of the Assessor’s Parcels within the boundaries of CFD No. 2023-1 that is not classified as Developed Property, Open Space Property, Property Owner’s Association Property, or Public Property.

“Unit” means (i) for Single Family Residential Detached Property, an individual single family detached residential unit, (ii) for Condominium Property, a residential condominium unit or townhome unit, (iii) for Apartment Property, an individual residential rental unit, (iv) for Hotel Property, an individual overnight lodging unit/room, and (v) and for ADUs, each residential unit. The number of Units assigned to each Assessor’s Parcel may be determined by (i) referencing Assessor’s

Data, (ii) site surveys and physical unit counts, and/or (iii) other research by the CFD Administrator.

“Welfare Exempt Property” means, in any Fiscal Year, all Parcels within the boundaries of CFD No. 2023-1 that (a) have been granted a welfare exemption by the County under subdivision (g) of Section 214 of the Revenue and Taxation Code indicated in the Assessor’s Data finalized as of January 1 of the previous Fiscal Year, and (b) are exempt from the Special Tax pursuant to Section 53340(c) of the Act.

B. DETERMINATION OF TAXABLE PARCELS

Each Fiscal Year, the CFD Administrator shall determine the valid Assessor’s Parcel Numbers for all Taxable Property within CFD No. 2023-1. If any Assessor’s Parcel Numbers are no longer valid, the CFD Administrator shall determine the new Assessor’s Parcel Number or Numbers in effect for the then-current Fiscal Year. To the extent a Parcel or Parcels of Taxable Property are subdivided, consolidated, or otherwise reconfigured, the Maximum Special Tax shall be assigned to the new Assessor’s Parcels Numbers pursuant to Section C. The CFD Administrator shall also determine: (i) the Tax Zone within which each Parcel is located; (ii) which Parcels are Taxable Property; (iii) the number of Units or Building Square Footage each Parcel contains; (iv) the property type, i.e., Condominium Property, Commercial Property, etc.; and (v) the Annual Special Tax Requirement for the Fiscal Year.

C. MAXIMUM ANNUAL SPECIAL TAX RATES

The Maximum Special Taxes for each Assessor's Parcel of Taxable Property shall be assigned below:

1. Maximum Special Taxes

The Maximum Special Tax for each Assessor's Parcel of Taxable Property within Tax Zone No. 1 shall be assigned according to Table 1 below:

**TABLE 1
MAXIMUM SPECIAL TAX RATES
TAX ZONE NO. 1
FISCAL YEAR 2022/23***

Land Use Category	Maximum Special Tax Rate	Per
Condominium Property – 1 Bedroom/Studio	\$262.22	Unit
Condominium Property – 2 Bedrooms	349.63	Unit
Condominium Property – 3 Bedrooms	437.04	Unit
Condominium Property – 4 Bedrooms	546.30	Unit
Condominium Property – 5 Bedrooms	682.88	Unit
Commercial Property	0.00	BSF
Apartment Property	0.00	Unit
Hotel Property	262.22	Unit
Single-Family Residential Detached Property	0.00	Unit
Accessory Dwelling Unit	See below	Unit

The Maximum Special Tax for an Accessory Dwelling Unit shall be calculated as a percentage of the Maximum Special Tax for the primary Unit the ADU is accessory to, based on Building Square Footage. For example, if a primary Unit in Land Use Category Condominium Property – 3 Bedrooms with 2,000 BSF has an ADU of 800 BSF, the Maximum Special Tax for the ADU shall be calculated by the following steps:

1. $800 \text{ BSF} / 2,000 \text{ BSF} = 0.40$ or 40%
2. $\$437.04 \text{ Maximum Special Tax per Unit} \times 40\% = \$174.81 \text{ Maximum Special Tax for such ADU}$

On July 1 of each Fiscal Year, commencing on July 1, 2023, the Maximum Special Tax rates for Tax Zone No. 1 shall be increased by amounts equal to two percent (2%) of the Maximum Special Tax rates amount in effect for the previous Fiscal Year.

Different Maximum Special Tax rates and tax escalation factors may be identified in Tax Zones added to CFD No. 2023-1 as a result of future annexations.

In some instances, an Assessor's Parcel of Developed Property may be Mixed-Use Property. The Maximum Special Tax levied on an Assessor's Parcel shall be the sum of the Maximum Special Tax for all Units and Building Square Feet of each property type on that Assessor's Parcel.

2. Assignment of Assessor's Parcel(s) to Property Land Use Category

When an Assessor's Parcel changes from being classified as Undeveloped Property to another land use category and is considered Developed Property, that assignment shall not change due to future changes in land use.

3. Assignment of Maximum Special Tax to Newly Created Assessor's Parcel(s)

When an Assessor's Parcel changes or subdivides, the Maximum Special Tax shall be assigned to each newly created Assessor's Parcel so that there is no net loss in the Maximum Special Tax revenue to be generated as a result of changes in the planned development.

When an Assessor's Parcel changes or subdivides, and there are changes to the overall planned development for each Tax Zone within CFD No. 2023-1, the process for assigning the Maximum Special Tax to each newly created Assessor's Parcel is as follows:

Step 1: Sum the expected Maximum Special Tax assigned to each Assessor's Parcel that is being changed or subdivided within that Tax Zone.

Step 2: Identify the newly created Assessor's Parcel(s) of Taxable Property created by the change or subdivision and assign the Maximum Special Tax to each newly created Assessor's Parcel of Taxable Property according to the then-current Maximum Special Tax Rates within that Tax Zone for each Land Use Category. Sum the Maximum Special Tax assigned to each newly created Assessor's Parcel of Taxable Property within that Tax Zone.

Step 3: Divide the total expected Maximum Special Tax in Step 1 by the total Maximum Special Tax assigned in Step 2 to arrive at a fraction for that Tax Zone.

Step 4: Apportion the total Maximum Special Tax from Step 1 to each newly created Assessor's Parcel of Taxable Property by multiplying each newly created Assessor's Parcel fraction, determined in Step 3, by the then-current Maximum Special Tax Rates within that Tax Zone for each Land Use Category.

Step 5: The Maximum Special Tax assigned to each newly created Assessor's Parcel of Taxable Property shall be the greater of the Maximum Special Tax assigned in Step 2 or the Maximum Special Tax calculated in Step 4 for the Tax Zone.

When an Assessor's Parcel changes or subdivides, and there are no changes to the planned development for each Tax Zone within CFD No. 2023-1, the Maximum Special Tax shall be assigned according to Table 1 for Tax Zone No. 1, or similar table for each successive Tax Zone.

The planned development for Tax Zone No. 1 is provided in the table below:

Land Use Category	Planned Development
Condominium Property – 1 Bedroom/Studio	101 Units
Condominium Property – 2 Bedrooms	4 Units
Condominium Property – 3 Bedrooms	4 Units
Condominium Property – 4 Bedrooms	4 Units
Condominium Property – 5 Bedrooms	3 Units
Hotel Property	149 Units

Once created, if a newly created Assessor's Parcel(s) of Taxable Property further changes or subdivides, the above steps shall be repeated to determine the Maximum Special Tax for the additional newly created Assessor's Parcel(s) of Taxable Property created from the change or subdivision.

D. METHOD OF APPORTIONMENT OF THE SPECIAL TAXES

All Taxable Property shall be subject to the Special Tax defined as follows. The Special Tax shall be levied each Fiscal Year by the CFD Administrator.

The Annual Special Tax Requirement shall be apportioned to each Parcel within CFD No. 2023-1 by the method shown below.

First: Determine the Annual Special Tax Requirement.

Second: Levy the Special Tax on each Parcel of Developed Property, Proportionately, up to the applicable Maximum Special Tax.

Under no circumstances will the Special Taxes on any Assessor's Parcel of Developed Property be increased by more than 10% as a consequence of delinquency or default by the owner of any other Assessor's Parcel within CFD No. 2023-1.

E. EXEMPTIONS

Notwithstanding any other provision of this Rate and Method of Apportionment of Special Tax, no Special Tax shall be levied on Open Space Property, Property Owner's Association Property, Undeveloped Property, Assessor's Parcels with public or utility easements making impractical their utilization for any use other than the purposes set forth in the easement, or Public Property, except as otherwise provided in Sections 53317.3, 53317.5 and 533401 of the Act.

No Special Tax shall be levied on any Assessor's Parcel in any Fiscal Year in which such Assessor's Parcel is classified as Welfare Exempt Property.

F. APPEAL OF SPECIAL TAX LEVY

Any property owner may file a written appeal of the Special Tax with the CFD Administrator claiming that the amount or application of the Special Tax is not correct. The appeal must be filed not later

than one calendar year after having paid the Special Tax that is disputed, and the appellant must be current in all payments of the Special Tax. In addition, during the term of the appeal process, all Special Tax levied must be paid on or before the payment date established when the levy was made.

The appeal must specify the reasons why the appellant claims the Special Tax is in error. The CFD Administrator shall review the appeal, meet with the appellant if the CFD Administrator deems necessary, and advise the appellant of its determination.

If the property owner disagrees with the CFD Administrator's decision relative to the appeal, the owner may then file a written appeal with the Town Council whose subsequent decision shall be final and binding on all interested parties. If the decision of the CFD Administrator or subsequent decision by the Town Council requires the Special Tax to be modified or changed in favor of the property owner, then an adjustment shall be made to credit the Special Tax in future years.

This procedure shall be exclusive and its exhaustion by any property owner shall be a condition precedent to filing any legal action by such owner.

G. INTERPRETATIONS OF RATE AND METHOD OF APPORTIONMENT

The Town reserves the right to make minor administrative and technical changes to this document that do not materially affect the rate and method of apportioning the Special Tax. In addition, the interpretation and application of any section of this document shall be at the Town's discretion. Interpretations may be made by the Town Council by ordinance or resolution for purposes of clarifying any vagueness or ambiguity in this Rate and Method of Apportionment of Special Tax.

H. MANNER AND DURATION OF SPECIAL TAX

The Special Tax shall be collected in the same manner and at the same time as ordinary ad valorem property taxes, provided that the Town may directly bill the Special Tax, may collect the Special Tax at a different time or in a different manner if needed to meet the financial obligations of CFD No. 2023-1, and may collect delinquent Special Taxes through available methods.

Special Taxes shall continue to be levied and collected within CFD No. 2023-1, as needed to fund the Annual Special Tax Requirement, in perpetuity.

I. PREPAYMENT OF SPECIAL TAX

The Special Tax may not be prepaid.

J. REPEAL OF SPECIAL TAX

If the levy of the Special Tax is repealed by initiative or any other action participated in by the owners of Assessor's Parcels in CFD No. 2023-1, the Town shall cease to levy the Special Tax and shall cease to be obligated to provide the authorized services for which the Special Tax was levied. The obligations to provide the authorized services previously funded by the repealed Special Tax shall become the joint obligations of the property owners of Assessor's Parcels within CFD No. 2023-1.

EXHIBIT D

TOWN OF MAMMOTH LAKES
COMMUNITY FACILITIES DISTRICT NO. 2023-1
(MAINTENANCE SERVICES)

NOTICE OF PUBLIC HEARING

Notice is hereby given that the Town Council of the Town of Mammoth Lakes will conduct a public hearing on Wednesday, April 5, 2023, at 4:00 p.m. or as soon thereafter as the matter may be heard, in the Town Council Chambers located at Suite Z, Minaret Village Shopping Center, 437 Old Mammoth Road, Town of Mammoth Lakes, California, or virtually as noticed by the Town, to consider the following:

TOWN OF MAMMOTH LAKES
COMMUNITY FACILITIES DISTRICT NO. 2023-1
(MAINTENANCE SERVICES)

On February 15, 2023, the Town Council of the Town of Mammoth Lakes adopted a Resolution entitled "A Resolution of the Town Council of the Town of Mammoth Lakes, State of California, Declaring Its Intention to Establish a Community Facilities District and to Authorize the Levy of Special Taxes Therein" (the "Resolution of Intention"). Reference is hereby made to the Resolution of Intention on file in the office of the Town Clerk of the Town of Mammoth Lakes for further particulars.

In the Resolution of Intention, the Town Council declared its intention to form the Town of Mammoth Lakes Community Facilities District No. 2023-1 (Maintenance Services) (the "District") to fund the costs of plowing and removal of snow, and maintenance of curbs/sidewalks, landscapes and streetlights and related appurtenances; and related appurtenances, as further identified in an exhibit to the Resolution of Intention. The proposed boundaries of the District were identified in another exhibit to the Resolution of Intention, and the Resolution of Intention identified a proposed special tax to be levied on real property to be included in the District to pay for the costs of the services.

In the Resolution of Intention, the Town Council provided that the levy of the special tax will be subject to a mailed ballot election among the owners of land in the District. The Town Council ordered the Town's Director of Public Works to prepare a report on the District, and the Town Council called for a public hearing on the District.

At the hearing, the testimony of all interested persons or taxpayers for or against the establishment of the District, the extent of the District or the furnishing of specified types of services will be heard. Any person interested may file a protest in writing with the Town Clerk. If fifty percent or more of the registered voters, or six registered voters, whichever is more, residing in the territory proposed to be included in the District, or the owners of one-half or more of the area of land in the territory proposed to be included in the District and not exempt from the special tax file written protests against the establishment of the District and the protests are not withdrawn to reduce the value of the protests to less than a majority, the Town Council of the Town shall take no further

action to establish the District or authorize the special taxes for a period of one year from the date of the decision of the Town Council, and if the majority protests of the registered voters or the landowners are only against the furnishing of a type or types of services within the District, or against levying a specified special tax, those types of services, or the specified special tax, will be eliminated from the proceedings to form the District.

Any person interested in these matters is invited to attend and present testimony either for or against the above item. If you challenge the proposed action in court, you may be limited to raising only those issues you or someone else raised at the public hearing described in this notice or in written correspondence delivered to the Town Council during or prior to the public hearing.

/s/ _____ Jamie Gray
Town Clerk
Town of Mammoth Lakes