

EXHIBIT B - Draft MACC Site Plan

MERIDIAN BLVD

AGENCY APPROVAL:

REVIEWING AGENCIES
STAMP HERE



Mammoth Lakes

HMC Architects

2375-009-100

3546 CONCOURS STREET
ONTARIO, CA 91764
909 989 9979 / www.hmcarchitects.com

NOT FOR
CONSTRUCTION

ISSUE

DESCRIPTION	DATE
-------------	------

KEYNOTES

- 02.29 REMOVE (E) LANDSCAPING
- 02.39 (E) PEDESTRIAN WALKWAY TO REMAIN
- 02.40 (E) ASPHALT PATH TO REMAIN, PROTECT IN PLACE
- 03.05 CONCRETE STAIRS & LANDING W. O.
- 05.65 GUARDRAIL
- 05.66 STEEL HANDRAIL
- 23.02 MECH EQUIPMENT, S.M.D.
- 26.07 SITE LIGHTING | ELECTRICAL
- 32.03 CURB RAMP, S.C.D.
- 32.04 CROSSWALK STRIPING, 4" WIDE BLUE BORDER WITH 4" WIDE WHITE PAINT HATCHED STRIPES @36" OC.
- 32.07 ISA PAVEMENT SYMBOL, SEE DETAIL 22A10.81.
- 32.10 TRUNCATED DOMES, S.C.D.
- 32.12 ACCESS AISLE W/ 4" WIDE BLUE BORDER WITH 4" WIDE WHITE PAINT HATCHED STRIPES @36" OC.
- 32.30 VAN ACCESSIBLE STALL
- 32.40 CONCRETE PATH | CIVIL
- 32.43 NEW ASPHALT PAVING | CIVIL
- 32.47 CONCRETE PAD, S.C.D.
- 32.49 PAVER & SUBSTRATE TO MATCH (E) ADJACENT PAVERS, S.C.D.
- 32.50 RELOCATED OR NEW FIRE HYDRANT, S.C.D.
- 32.51 BOLLARD, S.C.D.
- 32.52 (E) PARKING LOT ENTRY TO BE CLOSED OFF, FILL WITH LANDSCAPE TO MATCH ADJACENT LANDSCAPE.
- 32.53 ROLLED CONCRETE CURB, S.C.D.
- 32.54 PARKING STALL STRIPING W/ 4" WIDE BLUE BORDER, LANDSCAPE, S.C.D.
- 32.56 BOULDER TO BE RELOCATED FROM PROJECT EXCAVATION

LEGEND

- - - - - APPROXIMATE LIMIT OF WORK. REFER TO ADDITIONAL DRAWINGS FOR WORK WHICH MAY EXTEND BEYOND THIS APPROXIMATE LIMIT OF WORK LINE.
- PROPERTY LINE
- - - - - ACCESSIBLE PATH OF TRAVEL
- [Hatched Box] EXISTING BUILDINGS NOT IN SCOPE
- [Solid Grey Box] NEW BUILDING
- [Dashed Box] BUILDING OVERHANG
- [Diagonal Hatched Box] (N) PAVERS TO MATCH EXISTING
- [Stippled Box] (N) CONCRETE PATH | CIVIL
- [Dotted Box] MECHANICAL UTILITY YARD
- [Circle with X] FIRE HYDRANT, SEE CIVIL DWGS

NOTES

1. REFER TO SHEET G0.11 FOR TYPICAL SYMBOLS AND ABBREVIATIONS.
2. REFER TO CIVIL DRAWINGS FOR PAVING & UTILITY INFORMATION.
3. REFER TO MECHANICAL, ELECTRICAL, FIRE ALARM, FIRE PROTECTION, AND PLUMBING DRAWINGS FOR UTILITY INFORMATION.
4. CONTRACTOR IS RESPONSIBLE FOR REPAIR/REPLACEMENT OF ALL HARDSCAPE PLANTING OUTSIDE OF LIMIT OF WORK LINE FOR CONNECTION OF UNDERGROUND UTILITIES.

FACILITY:
MAMMOTH LAKES FOUNDATION
100 COLLEGE PKWY
MAMMOTH LAKES, CA 93546

PROJECT:
MAMMOTH ARTS & CULTURAL CENTER PHASE 2

SHEET NAME:
ENLARGED SITE PLAN

50% CD SUBMITTAL

DATE: 06/06/2024

CLIENT PROJ NO:

SHEET:

ENLARGED SITE PLAN **1**
1/16" = 1'-0"

PLEASE RECYCLE

A1.04

Autodesk Docs:2375009100.TDML Mammoth Arts Cultural Ctr Ph 2 Add2375009100-A-Arts_Cultural_Ctr_Ph2.rvt 6/7/2024 4:33:19 PM

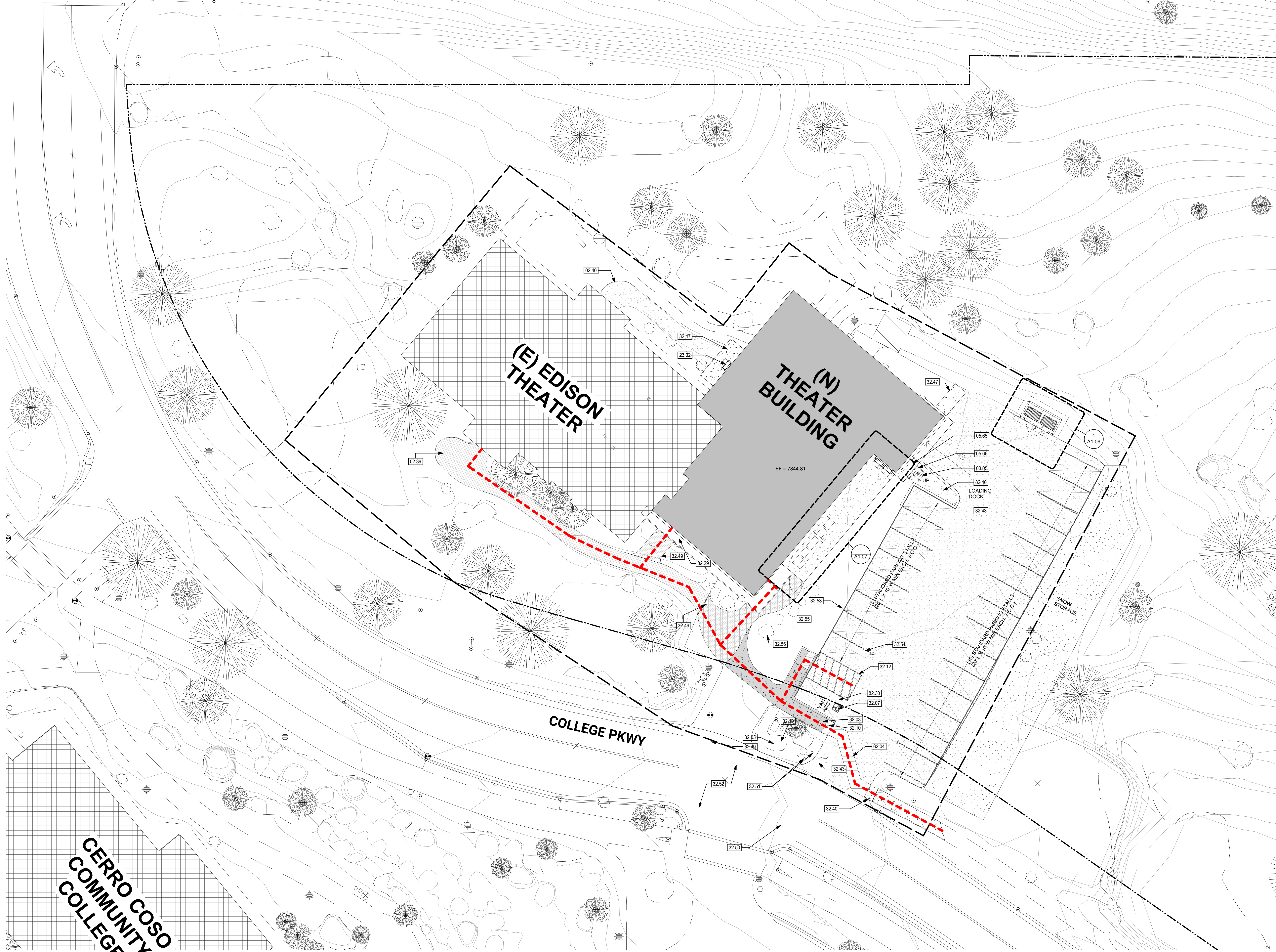

**CERRO COSO
COMMUNITY
COLLEGE**